

A 15772/STS/92
 Planning Permit No.
APPROVED
 SUBJECT TO THE CONDITIONS IN
 THIS OFFICE LETTER.
 No. A-1/17566/92 Date 7-92
 N.V. Nishanth
 1/12/92
 FOR MEMBER SECRETARY
 MADRAS METROPOLITAN
 DEVELOPMENT AUTHORITY
 MADRAS - 600 008.

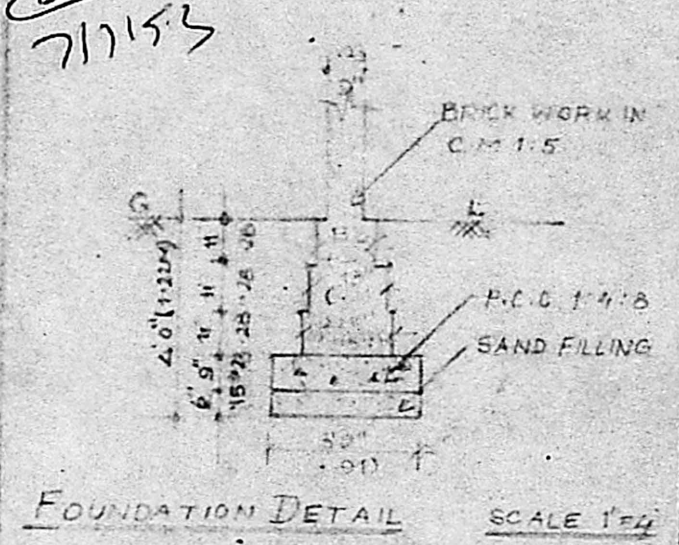
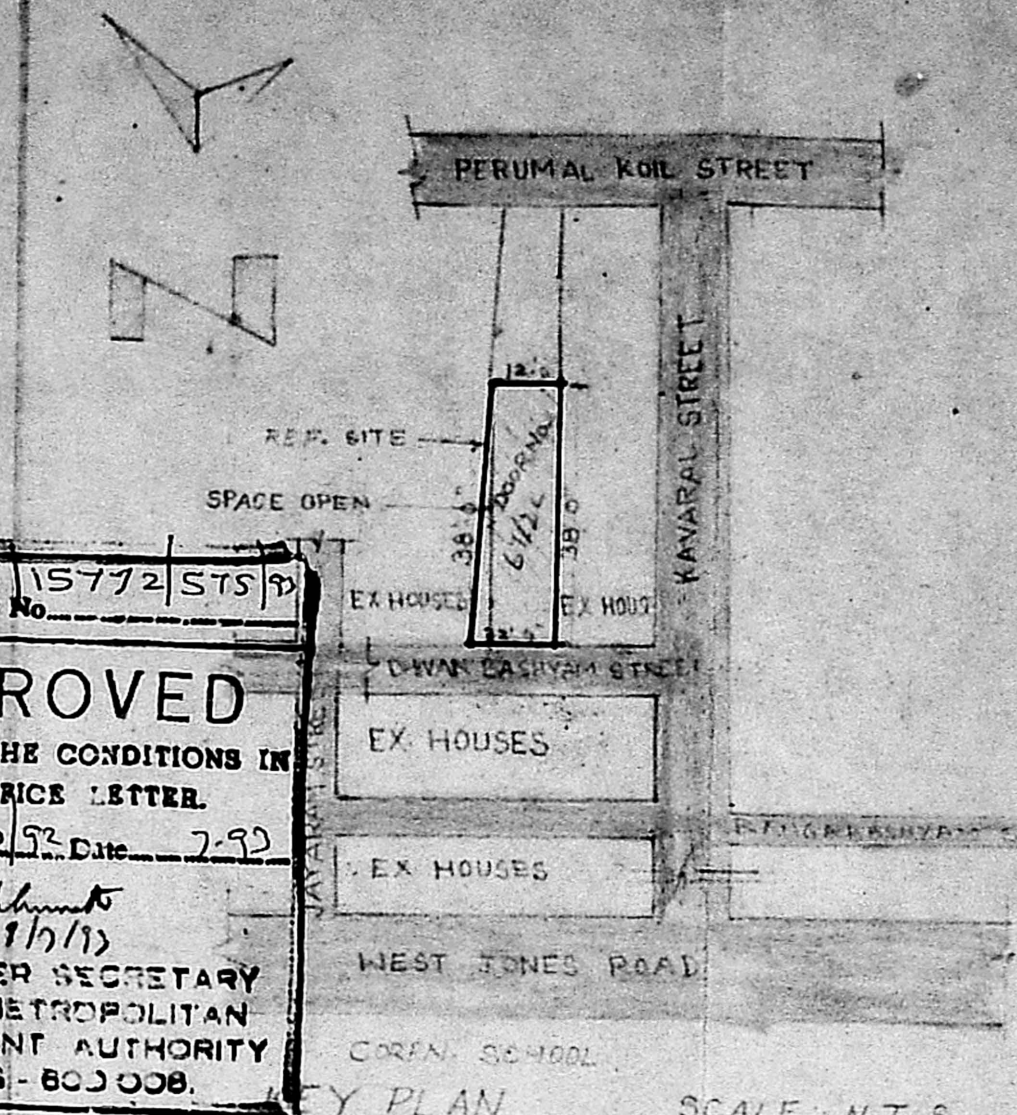

STAIR	
WIDTH	3'0" - 0.91m
TREAD	1'0"9" - 0.28m
RISE	1'0"7" - 0.17m
CALCULATED	
PROPOSAL	
BOUNDARY	
ROAD	
TO BE REMOVED	

SPECIFICATION :-
 ALL DETAILS AS SHOWN IN SECTION

- JOINERY:-**
- D - DOOR - 3'3" x 6'6" (1.99 x 2.00)
 - D₂ - DOOR - 2'6" x 6'6" (1.76 x 2.00)
 - J - RC JOLLY - 3'0" x 4'6" (1.91 x 1.37)
 - W - WINDOW - 4'6" x 4'6" (1.37 x 1.37)
 - V - VENTILATOR - 3'0" x 1'6" (1.91 x .45)

AREA STATEMENT

PLOT AREA = 489.35 SQ FT 45.53 SQ M
 GROUND FLOOR AREA = 315.5 " 29.3 "
 FIRST FLOOR AREA = 315.5 " 29.3 "

SCALE:- 1" = 8' (1:100)

OWNER:-

d. S. R. plan
 A/17566/92
 no. of copy 27/05/92

APPLICANT SIGNATURE

PLAN SHOWING THE PROPOSED CHANGE OF ROOF AND ADDITIONS TO
 A RESIDENTIAL BUILDING AT DOOR NO. 67/2C, PERUMAL
 KOIL STREET, SAIDAPET, MADRAS - 600 015.
 DIVISION - 135.

R. GNANASAMBANDAM, L.C.E.,
 CONSULTING CIVIL ENGINEER,
 AND V.E.U.R.,
 LICENSED SURVEYOR,
 CLASS II No. 43
 CORPORATION OF MADRAS,
 Res: 33 Sadasayappa Mudaly Street,
 SAIDAPET, MADRAS-600 015.

LICENSED SURVEYOR